

# BT30 / 40 ER 筒夾式刀桿(BT50 on request)

D03

### 產品特性說明

- 動平衡 G6.3 / 15,000 rev./min
- MAS/BT to JIS B 6339 form AD/B
- coolant supply form AD/B (BT30 無側邊出水設計)

- 包含鎖固螺帽
- 配合筒夾 鉗領編號 4307
- 配合扳手 鉗領編號 4913
- BT50 on request 另行報價

鉗領編號 **4245**

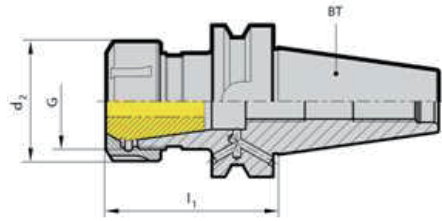

BT	夾持柄徑 d1 mm h6	d2 mm	G	l1 mm	Code no.
30*	ER16 1-10	32	M22x1.5	70	16,030
30*	ER25 1-16	42	M32x1.5	70	25,030
40	ER16 1-10	32	M22x1.5	63	16,040
40	ER25 1-16	42	M32x1.5	60	25,040
40	ER32 2-20	50	M40x1.5	70	32,040
40	ER16 1-10	32	M22x1.5	160	16,140
40	ER25 1-16	42	M32x1.5	160	25,140
40	ER32 2-20	50	M40x1.5	160	32,140

# BT30/40 高速加工機專用油壓刀桿 \* 中心出水 轉速可達 3萬轉/分

### Product information

- perfect concentricity: <math>< 3 \mu\text{m}</math> at 10xd1
- balancing quality: G2.5 / 25,000 rev./min
- MAS/BT to JIS B 6339 form AD/B (\*: versi on AD without coolant supply over collar) separately
- high clamping force
- quick, simple handling and accurate length setting
- IC and GÜHROJET peripheral cooling ensure optimal chip evacuation and tool lubrication

### Scope of delivery

- incl. length adjustment screw
- incl. hexagon chuck key Guhring no. 4912
- order pull studs Guhring no. 4927, 4928

鉗領編號 **4620**

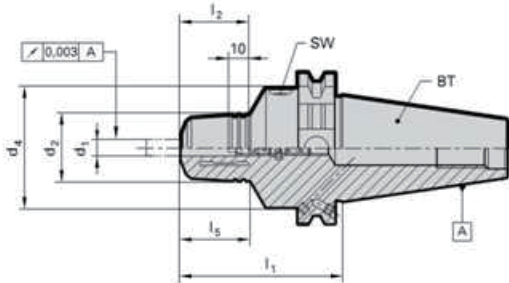

BT	夾持柄徑 d1 mm h6	d2 mm	d4 mm	l1 mm	l2 mm	l5 mm	SW	Code no.
30*	3	28	-	55	34	22.5	4	3,030
30*	4	28	-	55	34	22.5	4	4,030
30*	5	28	-	55	34	22.5	4	5,030
40	3	28	44.5	94	34	48.5	5	3,040
40	4	28	44.5	94	34	48.5	5	4,040
40	5	28	44.5	94	34	48.5	5	5,040